

CeramicSpeed Campagnolo OSPW installation manual



CERAMICSPEED CAMPAGNOLO OSPW INSTALLATION MANUAL

To ensure the very best riding performance, it is vital that your new OSPW System is mounted correctly. Follow these instructions to install your OSPW System for Campagnolo.

The different parts:

1. Back cage plate
2. Lower pulley
3. Upper pulley
4. Front cage plate

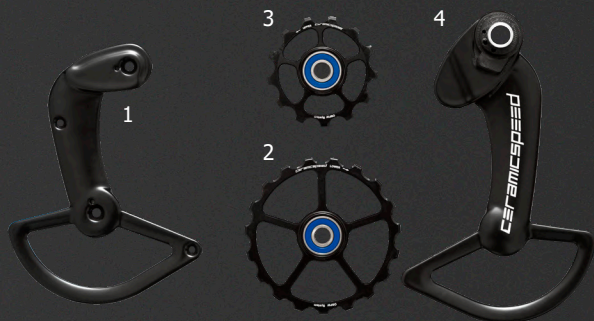

Tools required:

For the installation of your new CeramicSpeed Oversized Pulley Wheel System for Campagnolo (henceforth as OSPW System), you will need the following tools:

1. Allan keys: 2, 3 & 5mm
2. Phillips #1 Screwdriver
3. Chain Tool

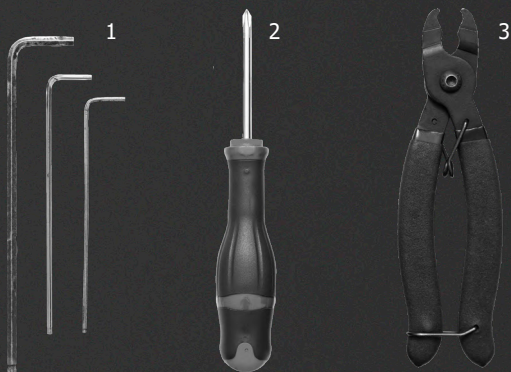

1. Begin with your bike mounted in a stand. Shift to the middle of the cassette (6th smallest rear cog), remove the wheel and then remove the chain.

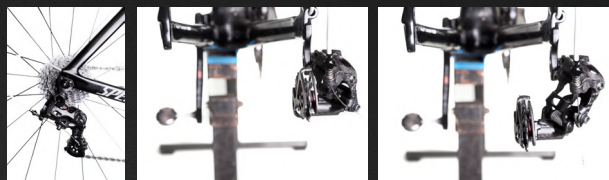

2. Using the proper tool, remove the original upper pulley wheel and loosen the lower pulley wheel bolt.

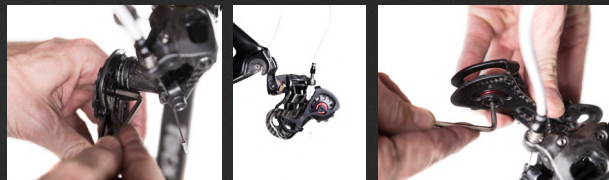

3. Loosen the pivot bolt, allowing you to remove the cage away from the derailleur body. Make sure to remove the metal washer from inside of the rear derailleur body.

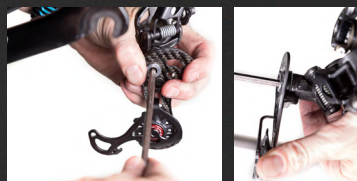

These 3 items should be reused

Pivot bolt metal washer spring

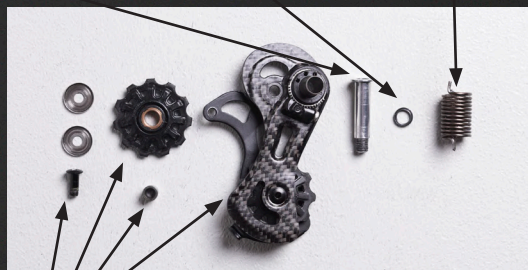

Should not be used

4. Insert the pivot bolt through the OSPW cage and place the metal washer over the threads. Apply grease on both.

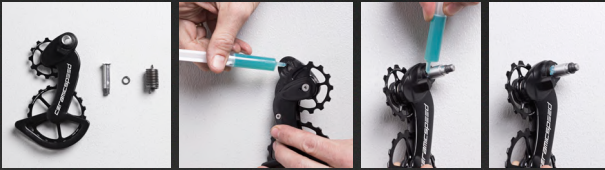

Apply grease to each end of the spring. Place one end of the spring in the middle hole, marked M on the front of the cage.



5. Assemble the OSPW with the derailleur body - making sure that the spring end fits into the hole at the bottom of the derailleur body.

Tighten the screw gently until it stops and make sure the cage is rotating free. It is at this point you must check that there is no play or gaps.

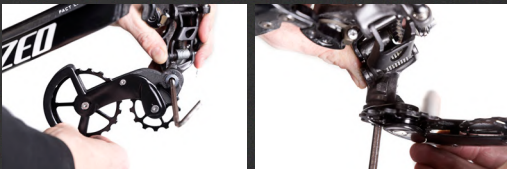

Turn the cage clockwise (seen from the left side of the bike) and loosen the pivot screw until the stop tower on the cages can pass the stop point on the derailleur housing. When the stop tower has passed the stop point on the derailleur housing, then re-tighten the pivot bolt.

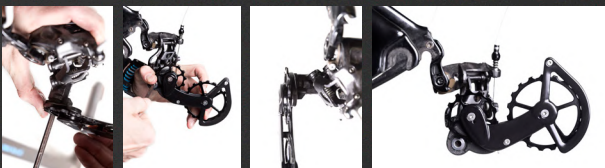

6. Install a new chain (approx. 112 or 110 links), shift to smallest cog (11T or 12T) and install the rear wheel.

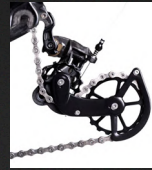

The chain must run over the tower



Adjust the gear shifting, making sure the high and low limits are positioned correctly. Test the bike carefully in all gears before using it on the road.

For those Campagnolo rear derailleurs that have a B-tension setting, it must be used to achieve correct gear setup. Some Campagnolo rear derailleurs don't have a B-tension adjustment. In this case simply adjust by chain length.

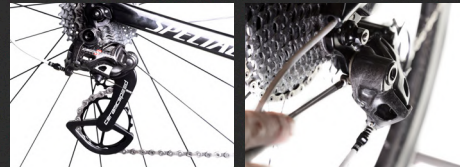

ATTENTION: Adjustment of the low limit on the Campagnolo EPS groupsets is electronic. You will need to make a general calibration of the gear shifting once the OSPW System is installed. As a part of this calibration the adjustment of the high and low stop positions will be done.

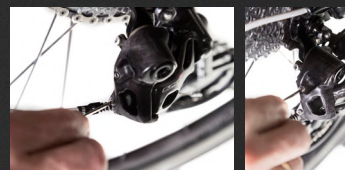

Regarding adjustment of Campagnolo EPS use the official Campagnolo web site where the zero setting of EPS is described.

CeramicSpeed OSPW assembly guide – chain length and tension

This document acts as a guide for achieving the correct chain length after mounting a CeramicSpeed OSPW. Please follow this guide in order to achieve precise shifting and performance of the OSPW System.

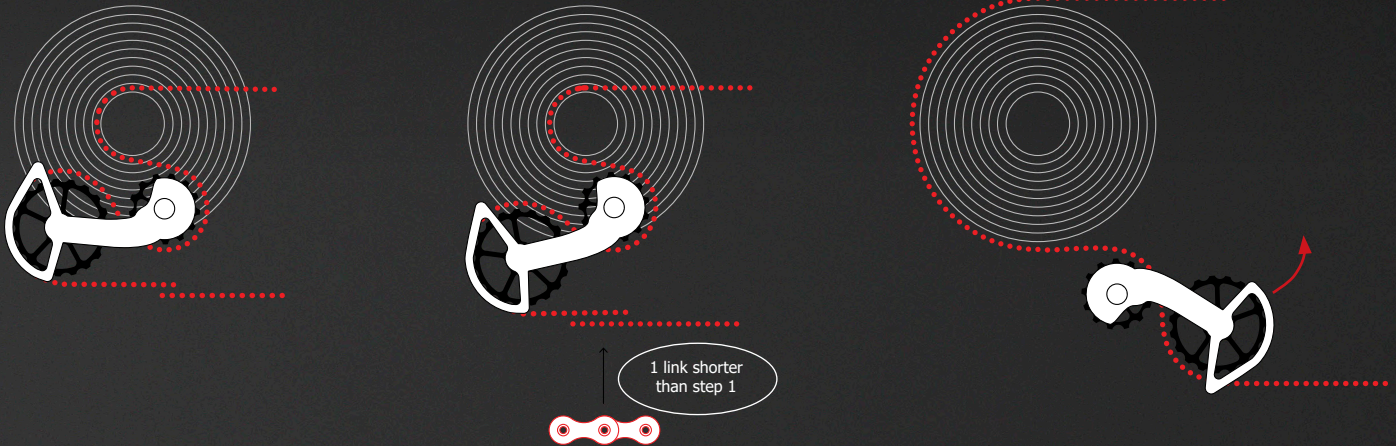

STEP 1: Place the chain on the small chain ring and the smallest cog on the cassette. To find the correct chain length, pull the two chain ends together, just as you would when needing to cut a chain to length. The lower part of the cage should start to move downwards, away from the cassette, as referenced in the second image.

STEP 2: When tension is applied on the chain and the OSPW System appears to be aligned as the diagram above, the chain needs to be cut (1 link shorter than step 1) and connected by the required amount of links in order to achieve sufficient tension in this gear combination (small chain ring/small cog on the cassette).

STEP 3: With the chain now cut to length it is important to test the clearance of the OSPW System when rear derailleur is set in the biggest chain ring and the largest cog on the cassette. Just as the arrow indicates the cage should be able to rotate counter clockwise. It is important that there is some clearance between the upper pulley wheel of the OSPW System and the largest cog on the cassette. If you find the clearance is not enough, adjust the B-tension accordingly. NB: Some Campagnolo RD's don't have a B-tension setting. In this case simply adjust by chain length. On Campagnolo (B-tension or not) choose either 110 or 112 links by selecting the longest that clears the longest cog.

Spring tension:

SRAM: Select the M spring tension hole (medium tension)

Shimano 9000/6800 series: Select the M spring tension hole (medium tension)

Shimano 9100/8000 series: Select the spring tension hole just beside L (second lowest tension)

Campagnolo: Select the M spring tension hole (medium tension)

Never use the L (lowest) tension hole – it's only a reserve for special situations. If rough road conditions or too slow shifting use the highest tension hole (H).